

GYPDECK 28



Product Information & Technical Data Sheet

Resonate **GYPDECK 28** is a high density, dry screed acoustic panel for floors. The panels incorporate a 10mm layer of **ResoFleece** a very high performance recycled soundproofing resilient layer.

The panels are installed below the floor finish and deliver excellent airborne and impact sound reduction. Noise reduction benefits vastly improve the living conditions for occupants, making them ideal for student accommodation, care homes and residential properties.

Dry Screed, Soundproofing Panels

The dry screed panels require no wet trades to install, significantly reducing build times. At only 28mm thickness, Resonate **GYPDECK 28** panels significantly reduce floor height in comparison to 40mm-50mm wet screed systems.

- 18mm top layer consists of an ultra high density recycled gypsum fibre panel.
- 10mm **ResoFleece** fibre resilient layer provides excellent impact sound performance.

Key Benefits



Excellent impact and airborne sound reduction

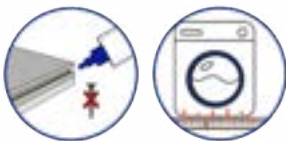

No screws, tongue and groove edge, high compressive strength

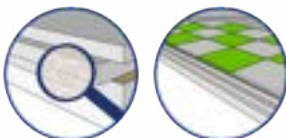

High density boards accept ceramic and porcelain floors directly without a decoupling mat



Dry system reduces build times. Does not burn when exposed to fire (non-combustible - A1 fire rating)



System Components

1. Resonate **GYPDECK 28** floor panel
2. **ResoEdge** flanking strip
3. Resonate **GYPDECK** Adhesive

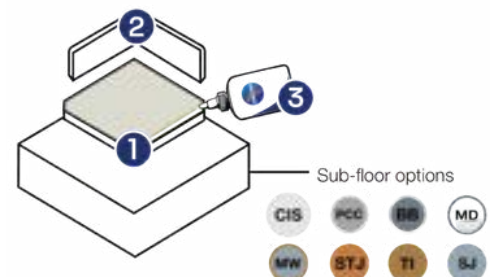

Dimensions

Panel Dimensions

600mm (W)
1200mm (L)
28mm (H)

Pallet Dimensions

1200mm (W)
1200mm (L)
1050mm (H)

Panel m²

0.72m² per panel

Pallet Weight

1060kg

Panels Per Pallet

66 panels / 47.5m²

Density

1200 kg/m³

Panel Weight

22.6 kg/m²
16 kg Per Panel

Robust Detail Compliant

E-FC-1 (FFT 4)

E-FC-2 (FFT 4)

E-FS-1 (FFT 4)



Product Applications and Typical Acoustic Performances

Concrete In-situ Floor CIS

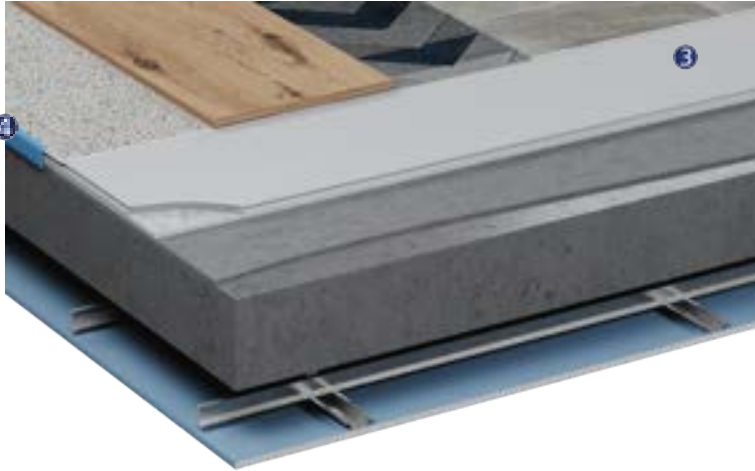

1. Ceramic Tiles / Timber flooring / Carpet / Vinyl
2. Electric UFH pipes set in tile adhesive
3. Resonate GYPDECK 28
4. ResoEdge L30 flanking strip
5. Levelling compound to achieve SR2 flatness
6. 200mm Reinforced insitu concrete slab
7. MF Ceiling (min 100mm void)
8. 1 x 9.5mm acoustic plasterboard

Airborne Sound Performance $D_{nT,w} + C_{tr}$	51dB
Impact Sound Performance $L_{nT,W}$	47dB
Impact Noise Improvement ΔL_w	22dB



Metal Web Timber Joisted Floor MW



1. Ceramic Tiles / Timber flooring / Carpet / Vinyl
2. Resonate GYPDECK 28
3. ResoEdge L30 flanking strip
4. 225mm (min) metal web timber joists
5. 100mm 45kg/m³ mineral wool
6. 30mm ResoBar resilient bars
7. 2 x 15mm acoustic plasterboard

Airborne Sound Performance $D_{nT,w} + C_{tr}$	50dB
Impact Sound Performance $L_{nT,W}$	56dB



Steel Joisted Floor SJ

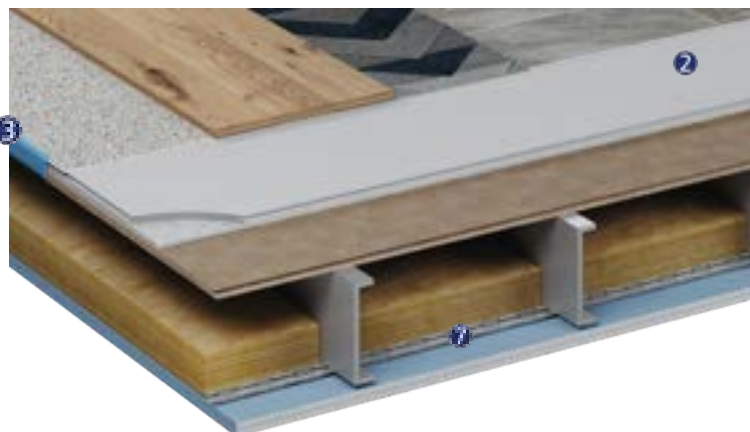

1. Ceramic Tiles / Timber flooring / Carpet / Vinyl
2. Resonate GYPDECK 28
3. ResoEdge L30 flanking strip
4. 18mm (min) timber sub floor
5. 225mm (min) steel floor joists
6. 100mm 45kg/m³ mineral wool
7. 30mm ResoBar resilient bars
8. 2 x 15mm acoustic plasterboard

Airborne Sound Performance $D_{nT,w} + C_{tr}$	50dB
Impact Sound Performance $L_{nT,W}$	56dB





Product Applications and Typical Acoustic Performances

Profiled Metal Deck Floor MD



1. Ceramic Tiles / Timber flooring / Carpet / Vinyl
2. Adhesive or decoupling layer
3. Resonate **GYPDECK 28**
4. **ResoEdge L30** flanking strip
5. Levelling compound to achieve SR2 flatness
6. 130mm concrete on profiled metal deck
7. MF Ceiling (min 100mm void)
8. 1 x 9.5mm acoustic plasterboard

Airborne Sound Performance $D_{nT,w} + C_{tr}$	52dB
Impact Sound Performance $L_{nT,W}$	47dB



Timber I-Joist Floor TI



1. Ceramic Tiles / Timber flooring / Carpet / Vinyl
2. Resonate **GYPDECK 28**
3. **ResoEdge L30** flanking strip
4. 225mm (min) timber i-joist floors
5. 100mm 45kg/m³ mineral wool
6. 30mm **ResoBar** resilient bars
7. 2 x 15mm acoustic plasterboard

Airborne Sound Performance $D_{nT,w} + C_{tr}$	50dB
Impact Sound Performance $L_{nT,W}$	56dB

